



IMPERIAL WEST

London

otl

IMPERIAL WEST

SPEC SHEET

SECTOR:

Student Accommodation

OUR CLIENT:

Crown House Technologies

END CLIENT:

Imperial College London

OTL PRODUCTS SPECIFIED:

300 OTL Ultimate Modular bathroom floors

PROJECT OVERVIEW

We recently embarked on a project of an impressive scale.

Imperial College London has created brand new student accommodation (Imperial West) and with over 300 bathrooms to install, they needed an innovative way of speeding up their bathroom pod production time. The majority of the bathrooms feature a bathtub rather than a wet room, and are therefore required modular floors with a difference; no gradient required, just fully pre-waterproofed floors!

Several rooms required walk-in accessible showers; no problem for On The Level. We formed the perfect gradient in order for water to drain away quickly. We pre-sealed and waterproofed the modular wet floor systems which meant building up-stands around the perimeter so that the first 50 mm of the wall could be also waterproofed – for added peace of mind.

For this project we worked with over 20 different room configurations ranging in size from 2200mm x 2100mm to 2800mm x 2000mm. Working closely with our designers using CAD software we had to be accurate ensuring the 'one piece' floors were built

within 1mm tolerance.

HOW DO CLIENTS BENEFIT FROM USING OTL ULTIMATE MODULAR FLOOR SYSTEMS?

- Time saving. Our modular flooring systems arrive to your site ready to install and tile immediately!
- Less project management. Our clients generally contract their work out, using many different trades to help complete a job. When using On The Level, the pressure is taken off their workforce as we supply the complete floor area, which is then fitted into The floor is pre-tanked (waterproofed) and ready to tile as soon as it is installed.

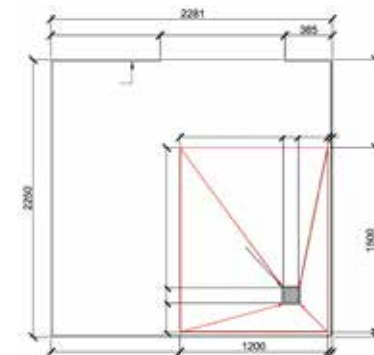



tanking thickness once cured is 0.8 – 1.3mm.

- Specifically designed to prevent leaks in wet room areas, the tanking liquid rubber solution can be applied to several surfaces including timber, plasterboard, MDF, concrete screed and construction boards.

This project is a fantastic opportunity for the team here at On The Level. To work with such a prestigious client is a huge deal for us. The modular wet floors are manufactured and built within our Bedfordshire manufacturing facility, where our team communicate with various people including project managers, operations managers, and members of the procurement team for our client.

HOW DOES THE TANKING PROCESS WORK?

Tanking, a way of waterproofing, is the method by which we use a flexible liquid rubber to seal and waterproof. The OTL Tanking system is a proven product, providing the client with 100% confidence of a leak free solution.

- Once the floor module (former) has been created and any imperfections levelled out, we apply our OTL liquid tanking solution to the product, – the

